

## SAVE THESE INSTRUCTIONS



This product is ETL listed and suitable only for indoor dry locations and approved for use at any height above the finished floor.

### ADJUST THE FIXTURE HEIGHT

- 1 Cut the coaxial cable to the desired length with a sharp cutter. The overall fixture height (H) is measured from bottom of the glass shade to end of the coaxial cable.

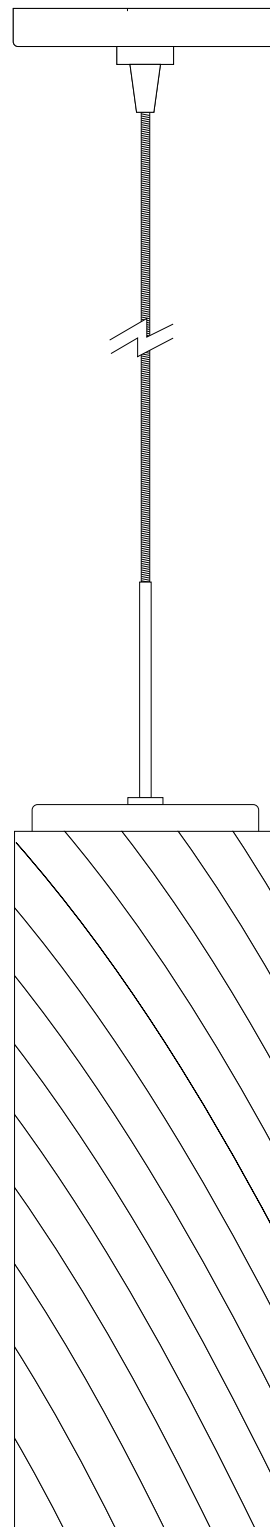
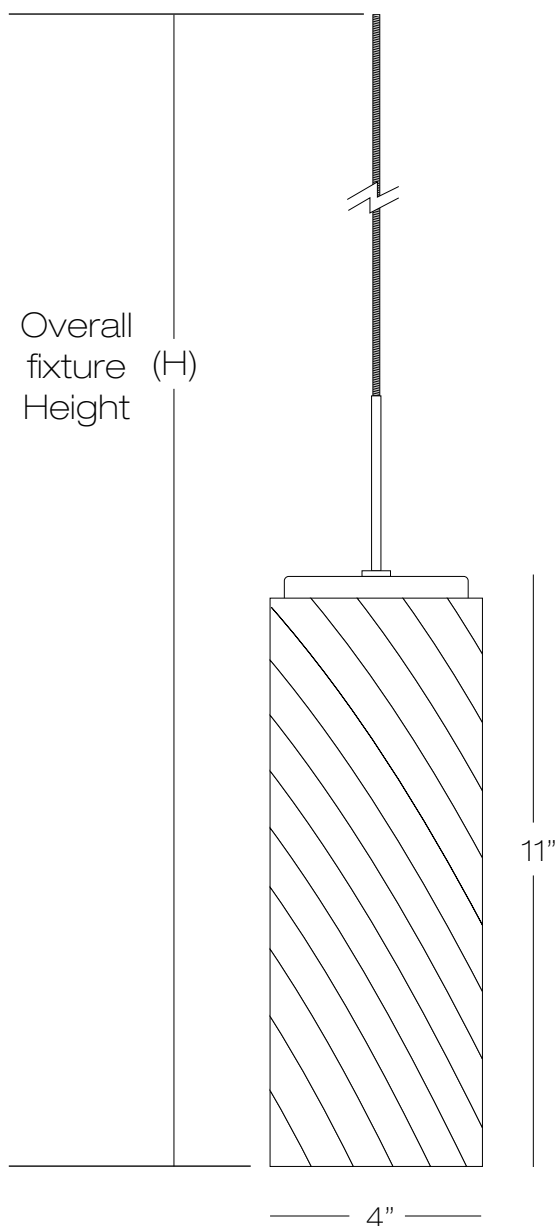

# Installation instructions for PD186 Gauss Low Voltage

## SAVE THESE INSTRUCTIONS



### CAUTION: RISK OF FIRE:

Never replace a Xenon (Xelogen) lamp with a regular Halogen lamp. A regular Halogen lamp requires a protective glass shield.

This product is ETL listed and suitable only for indoor dry locations and approved for use at any height above the finished floor.

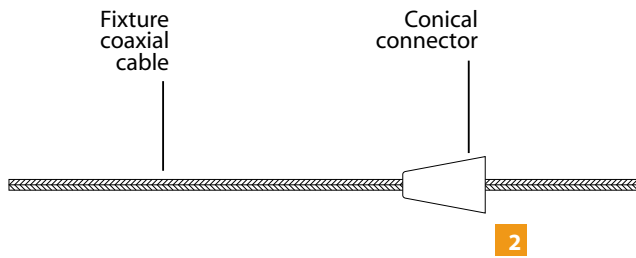

- 2** Insert the fixture coaxial cable through the conical connector



- 3** Insert the coaxial cable through the flared end of the strain relief.

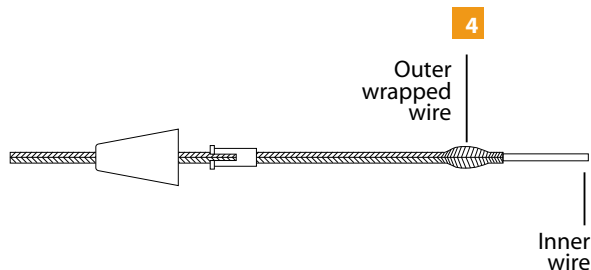

- 4** Slide the outer wrapped wire back to expose the inner wire.

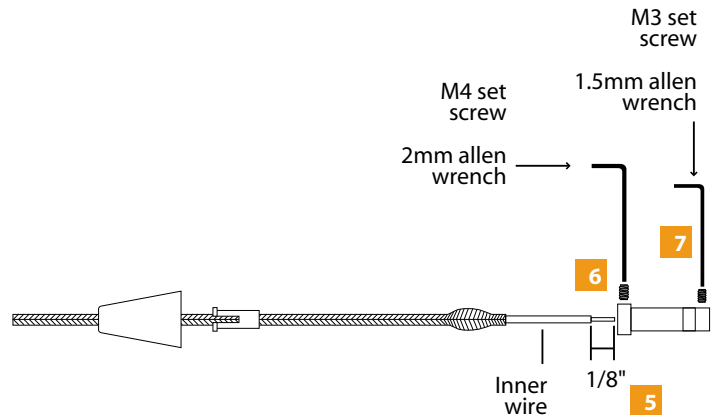

- 5** Strip 1/8" from end of the inner wire. Make sure that the stripped portion is not greater than 3/16".
- 6** Loosen (Do Not Remove) the M4 set screw with the provided 2mm Allen wrench.
- 7** Remove the M3 set screw with the provided 1.5mm Allen wrench.

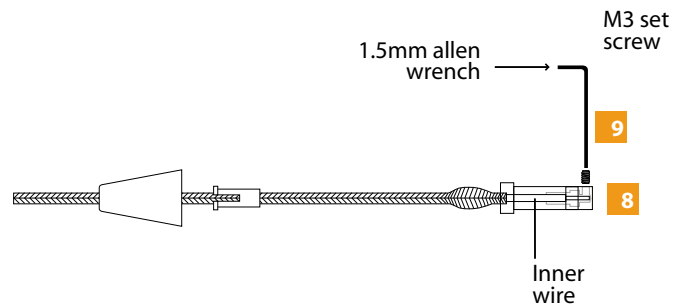

- 8** While inserting the inner wire into the connector look through the set screw hole to make sure that the stripped portion of the inner wire contacts end of the connector.
- 9** Hold the coaxial cable in place; replace and tighten the M3 set screw with the 1.5MM Allen wrench. Lightly tug on the coaxial cable to make sure that the set screw connection is tight.

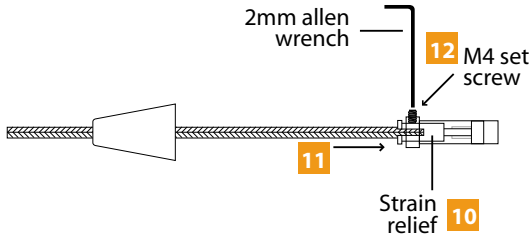

- 10** The strain relief slots should be rotated 90° away from the M4 set screw.
- 11** Slide and push the strain relief completely into the connector. This will force the outer wrapped wire to be inserted into the connector.
- 12** Tighten the M4 set screw with the 2mm allen wrench so that the strain relief holds the outer wrapped wire in place.

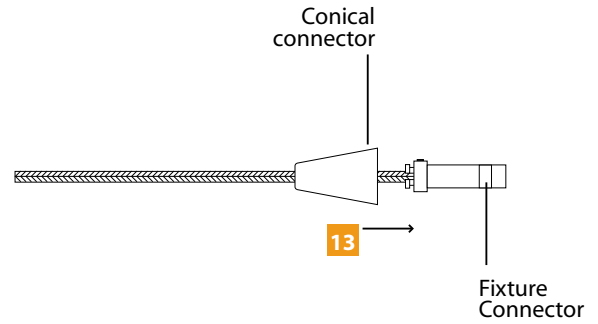

- 13** Slide the conical connector over the fixture connector.
- To install the fixture, refer to the instructions provided with the system.

## INSTALL THE FIXTURE

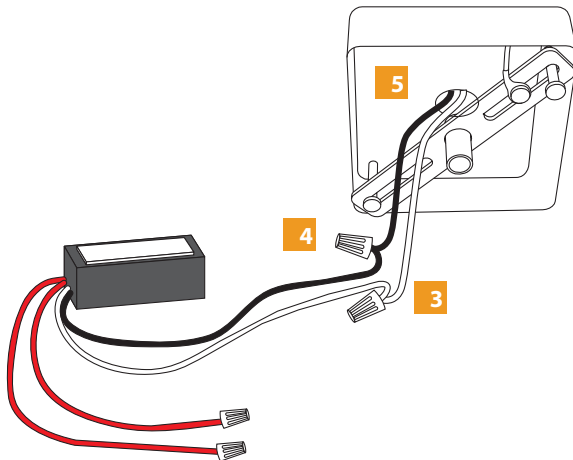

- 3** Connect the transformer white wire to the neutral power line wire with a wire nut.
- 4** Connect the transformer black wire to the hot power line wire with a wire nut.
- 5** Place the transformer inside the electrical box.

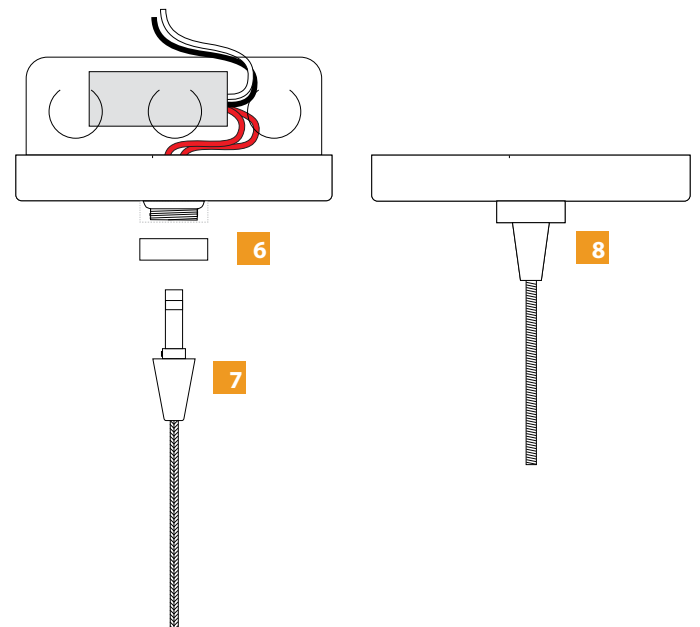

- 6** Insert Ring onto canopy thread.
- 7** Slide the conical connector over the fixture connector.
- 8** Tighten ring, do not over tighten.